



*2023 National Convention*

*Own Your Space*

*July 20-23, 2023*

**Sigma  Alpha**  
SORORITY

*Cultivating professional women. Advancing agriculture.*

## *Howdy Sisters,*

The Sigma Alpha National Sorority Board and I are excited to have you join us here in Omaha. We are thrilled that you have chosen to invest in yourself and your chapter by attending the 2023 National Convention. Our hope is for you to walk away from this week with something you can use in your growth as young professional and something you can take back to help your chapter grow and prosper, and for you to make a connection with another sister that will last a lifetime.

As women, we sometimes get overlooked or underestimated in the spaces we occupy. This can happen when we are applying for a new job, promotion, when we come to the table to negotiate a deal for our farm, a pay raise or a better contract or business deal for our company. But, with a little added insight from those who have already traveled this path, you can make yourself more visible and leverage being underestimated to your advantage.

This year's theme was strategically chosen to design programming to share knowledge and provide tools to help you better navigate these challenges and set yourself up for success. We're confident you'll find the weekend is filled with opportunities to learn how to use these tools and seek out resources so you can "Own Your Space!"

I look forward to connecting with you throughout the weekend.

*Kim Neumann*  
*National President*



# Convention Map

Floor 19

## EXECUTIVE MEETING CENTER

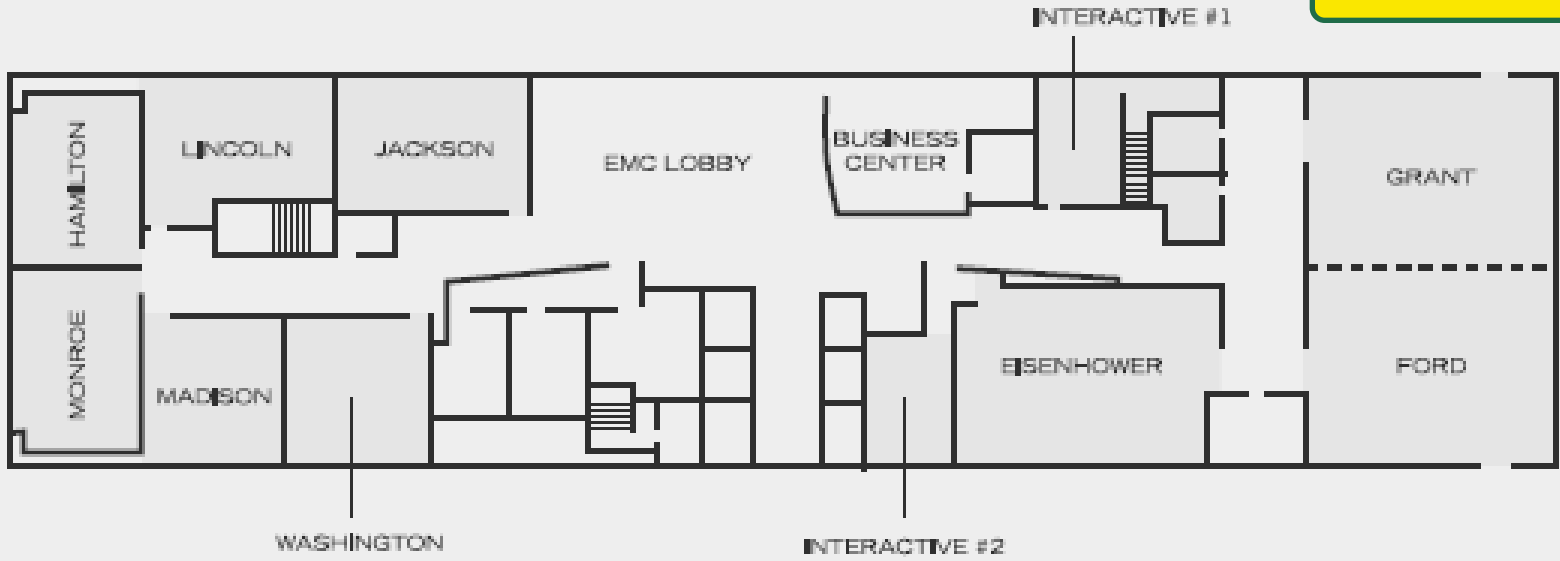

Floor 3

## BANQUET LEVEL

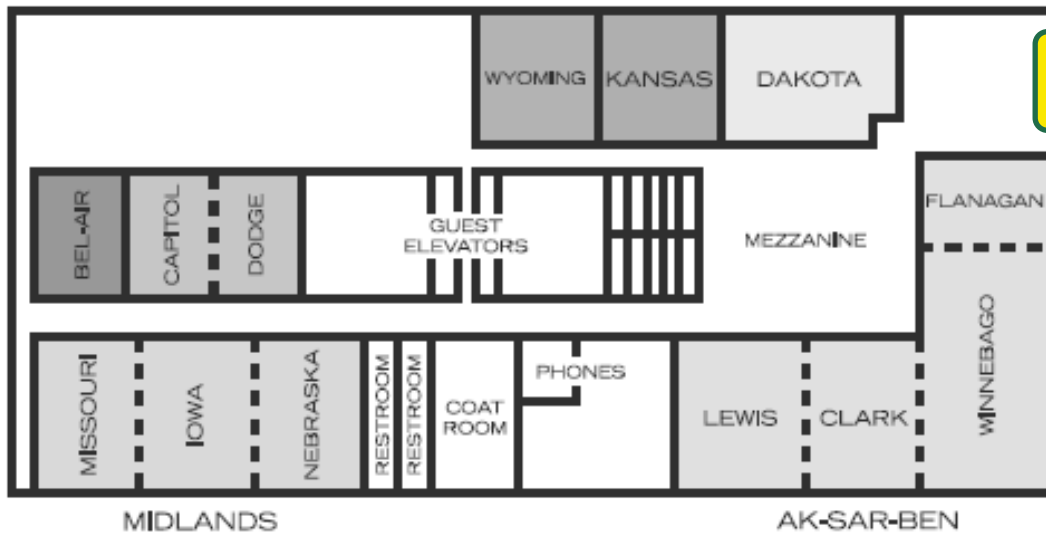

Floor 2

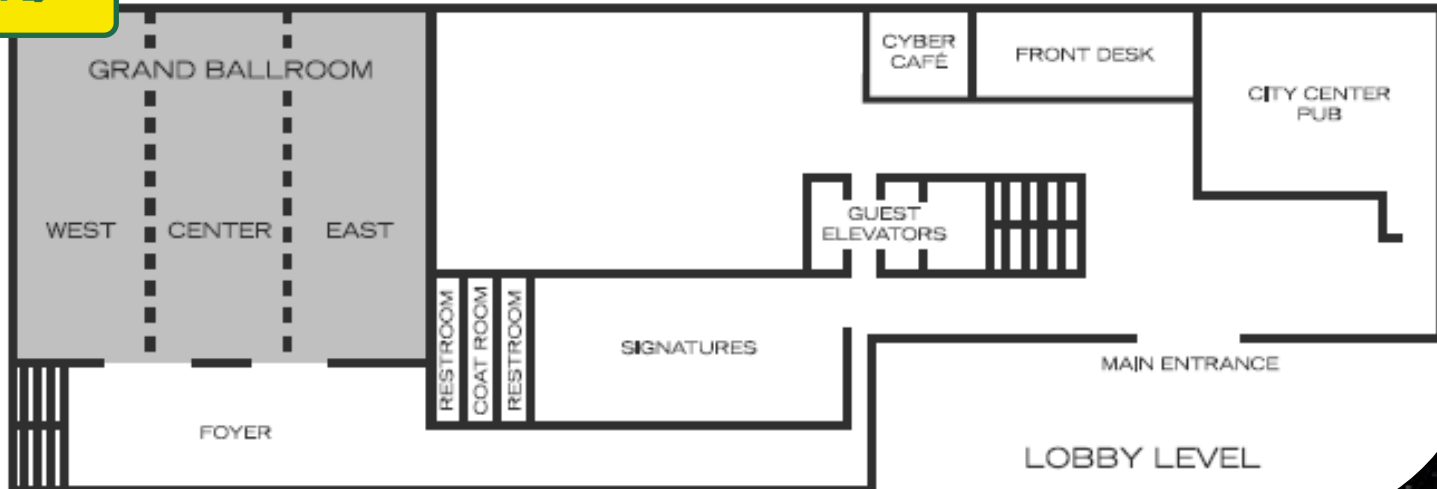

# Agenda

## Thursday, July 20, 2023

Registration <i>Mezzanine Registration</i>	7:00 AM -5:30 PM
National Pillar Awards Competition Check-In <i>Washington Foyer</i>	11:00 AM—Noon
Convention Welcome <i>Winnebago Room</i>	1:00—1:30 PM
National Pillar Awards Competition Presentation <i>Washington Foyer</i>	1:30 -4:30 PM
I'll Take Effective Meetings for \$1,000, Alex! <i>Winnebago Room</i>	1:30—4:30 PM
Break	4:30 -4:45 PM
Pillar Committees— <i>Delegates as Assigned</i> Leadership Committee— <i>Missouri Room</i> Fellowship Committee— <i>Dodge Room</i> Scholarship Committee— <i>Capitol Room</i> Service Committee— <i>Iowa Room</i> Finance & Ethics Committee— <i>Nebraska Room</i>	4:45—6:00 PM
Strategic Planning Sessions— <i>Non Delegates Choose 1</i> Recognition Programs— <i>Lewis Room</i> Member Satisfaction & External Image— <i>Clark Room</i>	4:45—6:00 PM
Choir Practice <i>Lincoln Room</i>	6:00— 6:30 PM
Cowgirls & Aliens Welcome Reception <i>Includes sisterhood closet &amp; marketplace, bring ID</i> <i>Grant/Ford Room</i>	7:00 -10:00 PM

## Friday, July 21, 2023

Spirit of Ruth Study <i>Grant Room</i>	7:00-7:30 AM
Registration <i>Mezzanine Registration</i>	7:00 AM -5:30 PM
Scholarship Breakfast <i>Ballroom East</i>	7:45—9:00 AM

# Agenda

Break	9:00—9:15 AM
Chapter Development Workshops ( <i>Choose 1 each round</i> )	9:15—11:50 AM
Round 1	9:15—10:00 AM
Your Chapter's Social Media Era— <i>Iowa Room</i>	
Let's Talk About It— <i>Clark Room</i>	
Be The Gravity in Ag Advocacy— <i>Lewis Room</i>	
The Art of Managing People— <i>Missouri Room</i>	
Round 2 ( <i>Rooms remain the same</i> )	10:10—10:55 AM
Round 3 ( <i>Rooms remain the same</i> )	11:05—11:50 AM
Fellowship Luncheon	Noon—1:15 PM
<i>Ballroom East</i>	
Personal/Professional Development ( <i>Choose 1 each round</i> )	1:30—3:15 PM
Round 1	1:30—2:15
3-2-1 Liftoff— <i>Iowa Room</i>	
Sincerely, Sigma Alpha— <i>Clark Room</i>	
Chart Your Course for Financial Success— <i>Lewis Room</i>	
Round 2 ( <i>Rooms remain the same</i> )	2:30—3:15 PM
National Service Project	3:30—4:30 PM
<i>Winnebago Room</i>	
Adjourn for the day—Dinner on your own	4:30 PM
Alumnae/Partner Networking Event ( <i>Invitation Only, Meet in Lobby</i> )	6:00 PM

## Saturday July 22, 2023

Zumba/Dance Aerobics	6:30—7:00 AM
<i>Nebraska Room</i>	
Registration	7:00 AM—2:30 PM
<i>Mezzanine Registration</i>	
Service Breakfast	8:00 —9:15 AM
<i>Ballroom East</i>	
Break	9:15—9:30 AM
National Chapter Congress	9:30—11:30 AM
<i>Ballroom West/Center</i>	

# Agenda

Leadership Luncheon <i>Ballroom east</i>	11:45—1:15 PM
Personal/Professional Development ( <i>Choose 1</i> ) One Small Step—Putting Your Best Foot Forward— <i>Iowa Room</i> A Healthy Mind—Your Greatest Asset— <i>Missouri Room</i> Connecting the Stars in Your Network - <i>Nebraska Room</i>	1:30—2:15 PM
All Attendee Photo <i>Lobby—main staircase</i>	2:15—2:30 PM
Free Time	2:30—6:00 PM
Choir Practice <i>Lincoln Room</i>	4:30—5:00 PM
Cocktails & Conversations <i>Midlands</i>	6:00—7:15 PM
Emerald Banquet <i>AK-SAR-BEN Room</i>	7:15—10:00 PM

*Thank you to our sponsors!*



## Chapter/Member Development Sessions

### *All Take Effective Meetings for \$1,000, Alex!*

**Presented by:** Teresa Brandenburg and Sara Holzschuh, National Headquarters Staff & Sigma Alpha alumnae

**Description:** The real winners will be you and your chapter after you spend an afternoon as a game show contestant in Sigma Alpha Studios. Spin the wheel and learn how to conduct a meaningful meeting in less time with engaged members while gaining momentum and increasing follow-through on discussion items.

Survey says... this workshop will revolutionize your meetings!

---

### *Let's Talk About It!*

**Presented by:** Kathryn Paulson, Sigma Alpha alumna from the Omega Chapter at South Dakota State University

**Description:** Join Kathryn as she guides chapter leaders and members on how to identify and support sisters' mental health concerns. Throughout this session, you'll discuss the difference between mental health and mental illness; warning signs and symptoms; resources; and tips on how to have those tricky conversations with our sisters during times of adversity.

### *Your Chapter's Social Media Era—How Does it Reflect You?*

**Presented by:** Angela Scott, Sigma Alpha alumna from the Alpha Iota Chapter at California State University, Chico

**Description:** Calling all collegiate sisters who currently manage their chapter's social media! Are you wondering how you can better showcase the pillars of the sorority in your chapter's posts? Have you ever had questions when it comes to social media and the Sorority dress code? Are you looking for new ways to increase following and engagement during your term? Any chance you're already feeling a little social media burnout? Never fear, in this session, Sigma Alpha National Communications Director, Angela Scott, will cover the best-practices when it comes to managing and promoting the chapter's social media pages and online presence and will share tips and tricks on how to manage the workload to avoid burnout.

## Chapter/Member Development Sessions

### *Be The Gravity in Ag Advocacy*

**Presented by:** Wendi Snider, Sigma Alpha alumna from the Alpha Zeta chapter

**Description:** In an ever changing world, one thing will absolutely remain...people must eat. That seems fairly simple but, as you know, agriculture encompasses the complexities of serving people who have access to information, yet know so little about the actual processes. In this session we will discuss solid Ag Advocacy strategies, ways to broaden your outreach and compelling and fun ways to positively engage your communities. Additionally, you will leave with a list of resources and ideas for your chapter that have little to no cost.

### *The Art of Managing People*

**Presented by:** Dave Erlbacher, Director at First National Bank of Omaha

**Description:** Join this accomplished manager as we dive deep into the space of member management, conflict resolution, and more!

---

### *3-2-1 Liftoff*

**Presented by:** Robyn Moffat, Senior Recruiting Manager and Jodie Spohr, Recruiting Manager at SiteOne Landscape Supply

**Description:** Blast off with the SiteOne team to learn the do's and don'ts of being part of the workforce. Take one giant leap into your career with a lively discussion around professionalism and networking. Let us help you make an out of this world impression on future employers. Join us on this journey as we reach for the stars!

### *Sincerely, Sigma Alpha*

**Presented by:** Katie Nolles and Renae Sieck, Sigma Alpha alumnae from the Alpha Delta Chapter at University of Nebraska.

**Description:** Do you want to land an interview for your dream internship or career? Join us to identify characteristics of exceptional cover letters and work on fine tuning your own to accomplish this goal. Please be sure to bring a cover letter you have written for an application in the past or one you hope to submit in the future.

## Chapter/Member Development Sessions

### *Chart Your Course for Financial Success*

**Presented by:** Nicholas Billings, alumnus of Creighton University and Investment Operations Associate

**Description:** It's your first day at your first job after college - you're up to your ears in paperwork - 401k's, taxes, budgets....why wasn't there a class on this in college? Have no fear! Join us to learn the down and dirty on budgeting, taxes, living within your means, and how to transition from a broke college kid to a not-so-broke adult.

---

### *One Small Step—Putting Your Best Foot Forward on Social Media*

**Presented by:** Angela Scott, Sigma Alpha alumna from the Alpha Iota Chapter at California State University, Chico

**Description:** Travel the entire galaxy of social media do's and don'ts as Angela discusses tips and tricks to represent your best-self online. You'll navigate customizing your social media presence to attain your personal goals and learn to avoid the asteroids and meteor showers of big social media mistakes. This session is great for anyone looking to build a stronger presence for ag-vocating, growing their platform or just plain FUN!

### *A Healthy Mind—Your Greatest Asset*

**Presented by:** Kathryn Paulson, Sigma Alpha alumna from the Omega Chapter at South Dakota State University

**Description:** This interactive discussion is focused on your personal mental health. The session will include tips for self-care, managing stress and burnout, and why mental health is your greatest asset!

### *Connecting the Stars in Your Network*

**Presented by:** Shelby Martin and Kellie Zambito, Sigma Alpha alumnae from the Beta Gamma Chapter at the University of Florida

**Description:** Networking can be as scary as exploring a new planet. As young professionals, it is important to build a network that will help you launch into your career endeavors. Join our space crew as we blast off in pursuit of understanding how to connect with others in your galaxy and explore resources that will equip you for your future networking opportunities.

## Workshop Presenters

**Teresa Brandenburg** is an alumna of the Delta Chapter and holds an Agriculture Education degree from Iowa State University. She lives and farms in Kansas with her husband and three boys and has worked at Sigma Alpha HQ since 2019.



**Sara Pope Holzschuh** graduated from Wilmington College in December 2019 with a bachelor's degree in agriculture policy and education. She was a charter member of the Gamma Alpha chapter and served as chapter president. She currently serves as the Region 7 Chapter Consultant.



**Kathryn Paulson** grew up on her family's farm near Clark, SD heavily involved in 4-H and FFA. The Omega Chapter was a huge part of her undergraduate experience where she gained lifelong friendships and connections! She continued her education at SDSU in the Clinical Mental Health Graduate Program where she assisted with research for the USDA Farm and Ranch Stress Assistance Network. She currently works as a Behavior Therapist for the SD Dept of Human Services in Redfield, SD and is working towards a license as a Professional Counselor.



## Workshop Presenters

**Angela Scott** graduated in 2016 from California State University – Chico with a bachelor's degree in animal science and a minor in agricultural business. She was vice president and recruitment chair of the Alpha Iota Chapter. In 2018, Angela began buying feeder cattle – that little side hustle has since grown to supply pasture-to-plate beef to the Dallas-Fort Worth area in her current home state of Texas. This fall, Angela and her husband will welcome their baby boy and future ranch hand to the family!



**Wendi Snider** is an ag girl through and through. She grew up on a small diversified livestock operation in TX and is an alumna of the Alpha Zeta chapter at Tarleton State University and National Sorority Board. Wendi currently resides on a small farm and serves as the Program Director for a Non-Profit organization called Saving Grace.



**Dave Erlbaucher** has had the privilege of growing his career at FNBO in our Omaha and Kansas City Markets for 14 years. In his current role, he strives to support the Omaha Branch Managers as they continue to thrive as leaders and coaches. The world of banking is constantly changing and he's excited to be part of it!

Outside of work, you can find him watching basketball (Go Jays!), reading, enjoying the outdoors, and traveling.



## Workshop Presenters

**Robyn Moffat** is currently the Senior Recruiting Manager of the East Division at SiteOne Landscape Supply. She and her team of 7 are responsible for staffing SiteOne branches in the Eastern half of the U.S. and Canada. Robyn joined the SiteOne family in 2016 and has a strong passion for student and diversity recruiting. Along with Michele Posehn, Robyn launched the SiteOne/Sigma Alpha Mentorship program in 2018 and has served as a professional mentor to Sigma Alpha sisters throughout the last 5 years.



**Jodie Spohn** currently serves as the Recruiting Manager for the West Division field recruiting team and is an active partner to the Diversity Initiatives and Early Talent team at SiteOne. She joined the organization two years ago and was eager to jump onto the team leading the charge with the Sigma Alpha partnership. Jodie joined SiteOne after having spent a few years working for a landscape contractor in a regional recruiting role. Her career has been coupled with a strong background in human resources and recruiting, and she brings a diverse background from large contract services, healthcare, higher education, and the



**Katie Nolles** grew up on her family's ranch near Bassett, Nebraska, where they raise purebred Hereford cattle. She graduated from the University of Nebraska – Lincoln with a bachelor's degree in agricultural education. While at UNL, Katie served as an FFA State Officer, National Hereford Queen, Vice President of Sigma Alpha – Alpha Delta Chapter, and competed on the Livestock Judging team. She is currently the agriculture education instructor and is pursuing a master's degree in School Counseling through Chadron State College.



## Workshop Presenters

***Renae Sieck*** grew up on a farm near Crete, Nebraska where her family raises Maine-Anjou show cattle. She attended the University of Nebraska-Lincoln where she obtained a bachelor's degree in animal science. She then stayed at UNL to complete a master's degree in animal breeding and genetics where her research focused on inherited disease and muscle physiology of beef cattle. She is now a professional services embryologist at Trans Ova Genetics. In this role she works with cattle producers to use embryo transfer as a tool to advance the genetic success of their herd.

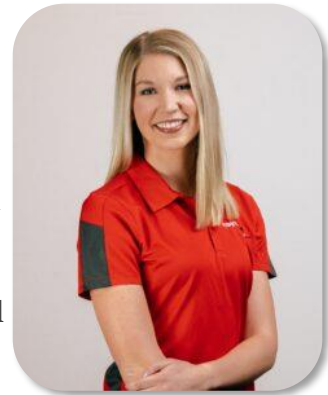

***Nicholas Billings*** graduated from Creighton University in 2019. Following his graduation, Nick was selected as one of 21 recent college graduates for Wells Fargo's prestigious Wealth & Investment Management (WIM) Analyst Program. Subsequently, he assumed the role of Product Manager, focusing specifically on supporting Priority Credit Line (PCL), the flagship lending product available for brokerage clients.



***Shelby Martin*** is an alumna of the Beta Gamma Chapter of Sigma Alpha at the University of Florida and graduated in 2019 with a Bachelor of Science in Public Relations. Shelby serves as the Communications Coordinator for Florida Farm Bureau and is responsible for creating and editing the monthly newsletter, preparing original articles for the FFBF website, e-newsletter and other media produced or managed by the Public Relations Division. Additionally, she assists the Director of Public Relations in Farm Bureau event promotions and other division projects.



## Workshop Presenters

*Kellie Lambito* is an alumna of the Beta Gamma Chapter who works as a business broker with Sunbelt Business Brokers of Tampa. Kellie has a background in strategic growth and business management, gained through developing her own business - a retail and wholesale ice cream shop which she purchased in 2019. After experiencing the process, she knew she wanted to help other business owners through the buying and selling process as well. She is a passionate advocate for the agriculture industry, educating consumers on where their food comes from, the intricacies of the food system from farm to table, and the safety of our food supply. She has continued her involvement with Sigma Alpha as an alumna: she served at a 2023 Sigma Alpha leadership Seminar Facilitator and served as the President of the Sigma Alpha UF Alumnae Chapter since 2020-2023.





## *Key Note Speaker*

Courtenay DeHoff is a highly sought-after keynote speaker, network television personality and cowgirl. With over fifteen years of experience as a television host, she boasts a wide skill set including shooting, editing and producing high quality content.

Armed with a passion to share stories on her own terms and give prominence to the agriculture community, Courtenay has utilized her expert storytelling skills to show being a cowgirl isn't how you look, where you live or even the lifestyle you lead. It's a state of mind.

As the founder of the global brand movement, Fancy Lady Cowgirl, she aims to celebrate women from all walks of life and teach them to lean into their true identity to reach new levels of success and fulfillment. Courtenay is on a mission to empower women from all walks of life to overcome feelings of unworthiness in order to unleash the cowgirl within and live legendary.



# 2022-2023 Emerald Scholar Recipients

The Emerald Scholar designation is bestowed upon collegiate members who upheld a 3.75 (4.0 scale) or higher cumulative GPA in the 2022-2023 school year, as such some of the names listed may have graduated in the fall of spring term prior to this year's National Convention. Chapter member GPAs must be submitted on chapter GPA reports to qualify for this award.

Congratulations to all 2022-23 Sigma Alpha Emerald Scholars!

## Alpha

Megan Argabright  
Molly Cordonnier  
Mackenzie Hoog  
Mary Catherine LeVan  
Claire Meyer  
Shelby Nicholl  
Sheriden Schuerman  
Betty Vorst  
Loryn Wright

## Beta

Megan Craig  
Madeline Fleshman  
Ellen Laffoon  
Jessika Mckee  
Savannah Nasrallah  
Ashlynn Olinger  
Kassidy Olinger  
Olivia Reynolds  
Lauren Ulrich  
Surena Urban  
Morgan Van Meter  
Sydney Wiesehan  
Katie Wilson  
Gamma  
Savannah Avent  
Madelyn Cary  
Noelle Chan

Abigail Chervin  
Sidney Collino  
Kiera Goward  
Megan LoPresto  
Morgan McVannel  
Aubrey Rasch  
Brooke Voelker

## Delta

Ashley Althaus  
Selia Becker  
Riley Bell  
Shade Bunker  
Megan Clark  
Caelan Engelbrechet  
Amber Engelken  
Abby Feldpausch  
Ashlyn Frederick  
Kelsey Henderson  
Jennifer Holliday  
Lindsey Jennett  
Lydia Johnson  
Mallory Kanne  
Kaylee Kleitsch  
Abigail Krause  
Faith Kuehl  
Bailey McKenna  
Macy Moore  
Malea Moore

Abbie Probasco  
Julia Quisley  
Addisoon Randall  
Brelynn Randall  
Morgan Schabacker  
Holly Schmitt  
Jordann Schneekloth

## Jenna Smith

Shelby Westhoff  
Lauren Zaabel  
Kathleen Zahm  
Epsilon  
Annabelle Boyd  
Julia Neideigh  
Zeta  
Alaina Esponge  
Mallory Miller  
Ellie Rosser  
Payton Tackett

## Eta

Vianna Bassani  
Emily Clifford  
Lindsey Cowden  
Sydney Klein  
Meghan Loftus  
Sofia Prata  
Anna Silkman  
Daria Soto

Hannah Trocchi

## Theta

Molly Castle  
Shelby Gleaves  
Moira Iastas  
Akela Martin  
Katelynn Parker  
Cara Rubin

## Iota

Delaney Roberts  
Jordan Thomas  
Mckayla Williams

## Kappa

(No Report Submitted)

## Nu

Danny Cupples  
Isabella Dentoni  
Delaney Helgans

## Xi

Adeline Rang  
Elia Rybolt  
Kaitlyn Schumacher  
Melanie Theall  
Hanna VanDeWalle

## Omicron

Makenna Baptist  
Kaitlin Campbell  
Sierra Davis

## 2022-2023 Emerald Scholar Recipients

Samantha Giordanengo	Katherine Filler	Rylee Johnson	Mikayla Martensen
Kaitlyn McDaniel	Cora Huhn	Tianna Kasperbauer	Cadee Nichols
Olivia Noack	Joelle Moorhouse	Makayla Mason	Samantha Oborny
Libby Reinsch	Josi Solsaa	Taylor Miller	Michelle Zenk
Sophia Seibert	Lindsey Vachal	Alexis Plackemeier	Kailey Ziegler
Carly Thompson	<b><u>Phi</u></b>	Malerie Schutt	<b><u>Alpha Epsilon</u></b>
Sophia Tulipana	Hailey Byrd	Kaitlyn Wilbers	<i>(No Report Submitted)</i>
<b><u>Pi</u></b>	Kayla Gossett	Bradlier Wilmes	<b><u>Alpha Zeta</u></b>
Justine Allyn	Ashlynn Sanders	Alpha Gamma	Annika Braaksma
Erin Armitage	<b><u>Chi</u></b>	Shelby Basham	Bailee Decker
Anna Cappellina	Lynne Thomas	Sophia Dell	Leanne Evers
Kristen Frick	Makenna Tressler	Cara Driskell	Abigail Grant
<b><u>Rho</u></b>	Jordyn Underkoffler	Hope Guebert	Aspen Hoover
<i>(No Report Submitted)</i>	<b><u>Psi</u></b>	Kelsey Knebel	Candace Landrum
<b><u>Sigma</u></b>	Katherine Hamilton	Cheyenne Lynch	Kalah Pressley
Bailey Barber	Sherita Hilton	Alexis Mueller	Brinn Vinklarek
Kate Jones	<b><u>Omega</u></b>	Dani Radtke	Megan Walton
Alivia Lantz	Kyerra Carter	Katie Richter	Hannah Willett
Allison Lloyd	Emma Eggenberger	Jennifer Rudolphi	<b><u>Alpha Theta</u></b>
Kylee Peters	Tessa Erdmann	Paige Ruppert	Kaitlyn Agostini
Charlie Weishaar	Hannah Flogstad	Marissa Schaefer	Madison Aloia
Bailey Barber	Amanda Kelling	<b><u>Alpha Delta</u></b>	Olivia Bondurant
Kate Jones	Emily Matejka	Jenna Albers	Ann Harthorne
Alivia Lantz	Emily Nold	Elsa Dick	Ellie Kitchin
Allison Lloyd	Zoey Schentzel	Sarah Eberspacher	Kathleen Marty
Kylee Peters	Karmen Sperr	Cevahn Ernesti	Kaylie Pender
Charlie Weishaar	Danesa Wilson	Sadie Ference	Cristina Sells
<b><u>Tau</u></b>	<b><u>Alpha Beta</u></b>	Victoria Ferrence	Malorie Woodard
Brooke Begovic	Mackenzie Barnard	Karlie Gerlach	<b><u>Alpha Iota</u></b>
Lanie Deyo	Sydney Bentz	Maddy Huwaldt	Lilly Baker
Elizabeth Hudgens	Morgan Blessing	Lauren Kaliff	Kayla Brown
Loni McKenzie	Olivia Dooley	Jenna Knake	Macy Paschoal
<b><u>Upsilon</u></b>	Margaret Fernandez	Ashley Kraemer	Ryann Vierra
Rivers Bachman	Meghan Hunerdosse	Jessie Lamp	

## 2022-2023 Emerald Scholar Recipients

### **Alpha Kappa**

Jacqueline Buckenberger

Maci Carter

Michelle Chavanne

Katarine Dedes

Carly Dillulio

Isabella Ferraro

Jessica Hagenow

Cathrine OLeary

Jacqueline Rima

Portia Sarkar

Hannah Slesinski

Ashley Streithorst

### **Alpha Lambda**

Erin Drake

Evie Sullivan

### **Alpha Nu**

*(No Report Submitted)*

### **Alpha Xi**

Makayla Hall

### **Alpha Mu**

Mallory Ames

Madeline Cook

Shannon Flavin

Emily Friese

Carli Hoffman

Sophia Hortin

Emma Kuhns

Carley Morrelli

Alexa Reavley

Pattanich Siludom

Taylor Talbert

Hannah Tappendorf

Margaret Vaessen

Julia Walli

Erin Wunderlich

### **Alpha Omicron**

Jackie Crea

Mikaela Dallas

Leah Lederer

Laughton Miller

Madison Perdue

Lillian Radney

Brooke Usher

Madeline Washburn

Kilie Wilson

### **Alpha Pi**

Madison Crick

Maggie Devrow

Katheryn Dreyer

Layna Fultz

Tess Homeyer

Kendall McComas

Keely Mikolajchak

Mallory Randig

Kylene Richards

Chloe Timm

Hannah Vierling

### **Alpha Rho**

Shirin Adang

Tatum Bingham

Gennavive Bordeaux

Claire Case

Aaike Dergance

Grace Hufford

Marisa Johnson

Hanna Kenerson

Samantha Loving

Gillian Perrett

Siena Perry

Isabel Ramirez

Ashton Redd

Reilly Rich

Anna Rogers

Susan Sharpe

Madeline Ware

### **Alpha Sigma**

Mikala Driscoll

Madeline Gates

Shaylee Owen

Nayelie Paredes

### **Alpha Tau**

Elena Tomchek

### **Alpha Upsilon**

Samantha Edwards

Katlyn Eversgerd

Kaitlyn Held

Abigail Herzing

Ava Isaacs

Shana Lueking

Emily Marsh

Grace Nalley

Madison Schuette

### **Alpha Phi**

Natalie Anselmo

Morgan Boer

Vivian Borba

Madelyn Fernandes

Icana Gonzalez-Esparza

Melissa Mines

Mayah Salas

Alyssa Salcedo

Alyce Silva

### **Alpha Chi**

Maddi Baker

Alivia Beanland

Grace Benton

Olivia Brune

Arianna Buchanan

Sarah Dillon

Madison Holmes

Lauren Keller

Caitlyn Kleffner

Abby Loesing

Carlee Long

Jadyn Lower

Madison Meyer

Ellie Monnette

Abigail Roberts

Sally Schmidt

Hannah Shanks

Sydney Stundebek

### **Alpha Psi**

Corrine Brown

Nicole DelConte

Jordan Gilles

Maria Kasipovic

Lainey Koval

Anna Spoth

### **Alpha Omega**

Alicia Bohren

Morgan DALbini

## 2022-2023 Emerald Scholar Recipients

Kady Figge

Lauren Fry

Alyssa Gray

Kylie Johnson

Abbigail Kleinsorge

Chanae Parker

Samantha Schwindt

Rachel Sebesta

Kaitlyn Seiwert

Alyssa Sherron

Kendra Siefker

Karlie Vossen

### **Beta Alpha**

Kaitlyn Drew

Raven Herron

Meghana Kotraiah

Nina McGranahan

Mary Parent

Ella Roth

Chase Thompson

Eliza White

### **Beta Gamma**

Avah Avonda

Katie Caren

Reanna Frauens

Jade Hua

Anna Terlizzese

Kathering Terlizzese

### **Beta Delta**

Allison Bradford

Danielle Chwala

Rachel Durst

Cassandra Luedtke

Jenny Spence

Sydney Van Swol

### **Beta Epsilon**

Cydnee Carter

Hailey Crawford

Katie Hebdon

Kaitlin Mirkin

Cassandra Moody

Haley Richardson

### **Beta Zeta**

Trinity Foster

Cassidy Hanover

Alexandra Liddicoat

Nadia van Doorn

Katie Zimmer

### **Beta Eta**

Kylie Weis

### **Beta Theta**

Samantha Brown

Natalie Weidenbach

Rachel Werner

Beta Kappa

Sarah Brautigam

Kelsi Devolve

Samantha DiNatale

Morgan Koskela

Kayla Royce

Diana Stover

### **Beta Mu**

Morgan Barba

Nicole Biermann

Morgan Lange

Aundrea Lund

Taylor Nulik

Regan Perry

Jozie Schilke

### **Beta Nu**

Lexi Cindrick

Marian Harrell

Emma Harris

Rachel Holberg

Lizzy Parks

Alayna Stapleton

Rachel Wood

Caitlynne Youmans

Abigail Zerwig

### **Beta Xi**

Chloe Albrecht

Gabby German

Jenna Goeken

Mackenzie Griffin

Email Klauer

Paige Tedford

### **Beta Omicron**

Emma Burr

Kennedy Burr

Bailey Carignan

Sam Klotz

Jillian Lujan

Casey Montgomery

Charity Moore

Katelyn Reese

Alex Sawinski

Jensen Smith

Madison Wilmoth

Jen Zimmerman

### **Beta Pi**

Reese Ryan

Breanna Zupan

### **Beta Rho**

Stinson Battisto

Dakota Cassidy

Kaylea Courtney

Kyleen Hewitt

Annabel Minor

Ainsley Purifoy

Sara Sweat

### **Beta Tau**

Rylee Kelley

Blakely Williams

### **Beta Upsilon**

Sarah Broadway

Maggie Clifton

Olivia Cresswell

Emma Palmer

Abby Wilson

### **Beta Phi**

Erika Conhiser

River Crepps

Amber Galyen

Leah Grayson

Kayla Riley

Elizabeth Shatto

Alexus Stapleton

Elaina Thibeault

Kellie Wells

# 2022-2023 Emerald Scholar Recipients

## **Beta Chi**

Erin Brown

Savannah Ganahl

## **Beta Psi**

Grace Adams

Erynn Allison

Katelin Bean

Olivia Bellah

Audrey Bishop

Abigail Bolar

Jodee Borgerding

Reagan Conrad

Monica Ferris

Lily Gisclair

Reese Gonsalves

Amber Holland

Payton Irick

Lauren Jones

Brook Langford

Morgan Maloney

Ellie Peterson

Mattie Pettus

Cayden Pricolo

Laney Reasner

Carrie Rhoades

Macy Rosselle

Jorja Scherler

Carmen Sieren

Samantha Starcher

Cali Wheeler

Laura Wuebker

## **Beta Omega**

Martha Lum

Emma Van Gemert

## **Gamma Alpha**

Sarah Cole

Heidi Edens

Allison Fortney

Emily Hoene

Courtney Luderman

Paige Teeters

Chloee Thomas

Kaylee Warfield

Kristen Whitaker

Ava Young

## **Gamma Beta**

Andee Baker

Cassidy Green

Siera Harrison

Audrey Malcolm

Maci Moore

Caroline Roeder

Grace Smith

Gamma Delta

Kylin Hemmings

## **Gamma Epsilon**

Christie Knapp

Skyler Maynard



# 2023 Sigma Alpha Regional Pillar Awards

## Region 1

	<i>Fellowship</i>	<i>Scholarship</i>	<i>Leadership</i>	<i>Service</i>
<b>1st Place:</b>	Gamma Beta	Alpha Iota	Xi	Alpha Iota
2nd Place:	Alpha Iota	Xi	Alpha Iota	Gamma Beta
3rd Place:	Alpha Phi	Gamma Beta	Beta Omega	Alpha Phi

## Region 2

<b>1st Place:</b>	Alpha Rho	Beta Mu	Alpha Omega	Alpha Rho
2nd Place:	Alpha Nu	Alpha Nu	Alpha Rho	Nu
3rd Place:	Alpha Sigma/Beta Mu/Nu	Alpha Sigma/Nu	Nu	Alpha Sigma/Beta Mu

## Region 3

<b>1st Place:</b>	Delta/Omega	Delta/Alpha Delta	Alpha Delta	Omega
2nd Place:		Omega	Omega	Delta
3rd Place:	Alpha Delta/Upsilon	Alpha Chi	Delta	Alpha Delta

## Region 4

<b>1st Place:</b>	Beta Upsilon	Alpha Zeta	Beta Upsilon	Alpha Pi
2nd Place:	Alpha Pi/Zeta	Beta Upsilon	Zeta	Beta Upsilon
3rd Place:		Zeta/Alpha Eta	Alpha Eta	Alpha Eta

## Region 5

<b>1st Place:</b>	Sigma	Beta	Alpha Mu	Alpha Mu
2nd Place:	Beta Delta	Beta Delta/Beta Xi	Sigma	Alpha Gamma
3rd Place:	Alpha Mu		Beta Delta	Beta Delta

# 2023 Sigma Alpha Regional Pillar Awards

## Region 6

	Fellowship	Scholarship	Leadership	Service
1st Place:	Psi	Theta	Theta	Psi
2nd Place:	Beta Tau	Beta Theta	Beta Theta	Theta
3rd Place:	Beta Theta	Beta Rho	Beta Eta	Beta Theta/Beta Rho

## Region 7

1st Place:	Gamma Alpha	Gamma Alpha	Gamma Alpha	Gamma Alpha
2nd Place:	Beta Chi	Beta Chi	Beta Omicron	Alpha Upsilon
3rd Place:	Alpha Upsilon	Alpha Upsilon	Alpha Upsilon	Beta Chi

## Region 8

1st Place:	Eta	Eta	Eta	Alpha Psi
2nd Place:	Alpha Psi/Alpha Kappa	Alpha Lambda	Alpha Lambda	Eta
3rd Place:		Alpha Kappa	Alpha Psi	Alpha Lambda

## Region 9

1st Place:	Beta Nu	Chi	Beta Nu	Beta Nu
2nd Place:	Alpha Theta	Beta Alpha	Beta Alpha/Chi	Beta Alpha
3rd Place:	Alpha Omicron	Tau		Pi



**GREEK  
CAPITAL  
MANAGEMENT**

[www.greekcapitalmanagement.com](http://www.greekcapitalmanagement.com)



# PROUD PARTNER IN YOUR SUCCESS

*SiteOne® Landscape Supply is honored to be an official sponsor of the Sigma Alpha sorority*

## ANNOUNCING OUR \$5,000 SCHOLARSHIP

Sigma Alpha sisters participating in our mentorship or internship programs in 2024 are eligible to be considered for a \$5,000 scholarship. Our mentorship program is exclusive to Sigma Alpha sisters, partnering students with female SiteOne associates to discuss topics related to job readiness and personal growth.

**Let's connect today! Please reach out to Michele Posehn to learn more about our partnership.**

*Join fellow Sigma Alpha sisters as a paid SiteOne intern at locations all over the US, and be a part of the green industry's fastest-growing wholesale supplier in nursery, agronomics, irrigation, lighting, and hardscapes.*

**Michele Posehn** [MPosehn@SiteOne.com](mailto:MPosehn@SiteOne.com)

**630+**  
LOCATIONS  
**6000+**  
ASSOCIATES



Scan here to visit our Careers page.  
[SiteOne.com/Careers](https://SiteOne.com/Careers)





*Be innovative.*  
**Be Bayer.**

At Bayer, we're pioneering with technology and digitalization, paving the way for us to achieve the unimaginable like helping farmers grow food more sustainably to help nourish the world. If you want to be part of something bigger and make an impact on our purpose, Science for a better life, visit [career.bayer.us](https://career.bayer.us) and apply today. You belong at Bayer!

 Science for a **better life**

## *Sisters,*

Thank you for joining us this past week in Omaha. We hope you leave feeling starry eyed and ready to own your space!

As you journey home, take a moment to reflect and document the constellations you've discovered and bring them...

- ◆ To your chapter
- ◆ To your professional life
- ◆ To your personal life

The space we own as Women in Agriculture is unique and powerful. Now go and shine your light throughout the universe.

*Kim Neumann*

*National President*